

# Silver Interlude

A silver-tone pool frame blended with a unique pool wall pattern creates a pool designed to fit any backyard.



**HII** HOLLOWELL  
INDUSTRIES  
INCORPORATED

# Silver Interlude



## Quality Features

- **Beautifully crafted 8" resin top rails and 8" resin verticals** in a silver-tone color.
- **52", hot-dipped galvanized copper bearing steel wall.**
- **Space Saver Oval Support System** allows larger pools to fit into smaller backyard settings. Plus, it is easy to install.
- **Corrugated pool wall** for flexibility and vertical strength.
- **Staggered bolt wall closure** provides maximum strength and wall stability.
- **Large, pre-punched skimmer and eyeball return openings** eliminate sharp edges that could cut the liner during installation
- **Available in an array of sizes:**  
**Round:** 12', 15', 18', 21', 24', 27', 30'  
**Oval:** 24' x 12', 30' x 15', 32' x 16', 33' x 18'
- **30 Year Limited Warranty on all pool components.**  
The first 3 years of our pool warranties are covered 100% against manufacturer defects (the remainder of each warranty is prorated). The bottom rails receive a Lifetime 100% warranty.



**IMPORTANT:** The "No Diving" and other Warning signage provided must be installed on each pool as indicated in the instructions provided.

**NOTE:** In some photos of the pools in the brochure (or web site), the "No Diving" and other Warning signage may not be visible, such Warning Signage must be installed as indicated in the instructions provided.

Hollowell Industries, Inc. stands behind every product we produce pursuant to those representations which are stated in our written warranties. Your dealer/builder/installer/contractor is an independent business and not an agent/representative or employee of Hollowell Industries, Inc. We cannot and do not accept any responsibility for any representations, statements or contracts made by any dealer/builder/installer or contractor.

Change of Design: Embassy PoolCo expressly reserves the right to change or modify the design and construction of any product in due course of our manufacturing procedures without incurring any obligation or liability to furnish or install such changes or modifications on products previously or subsequently sold.

# AQUA-TRU

## EMBASSY LINERS



### Quality Features

- Aqua-Tru liners are sealed using **Therma-Seal™ Technology** - a new, proprietary fusion method providing superior sealing for maximum durability and quality. Unmatched in the industry, this process uses the best technology available.
- Aqua-Tru liners have a 15 year limited warranty. The first 3 years of these liner warranties are covered 100% against manufacturer defects. The remainder of the warranty is prorated.
- The **Ultraviolet Inhibitors** protect the liner from the sun's rays as well as enhance longer life.
- These Aqua-Tru liners have been specially designed to be **wrinkle-free** when used for those economical, kick-in installations.
- Liner sidewalls and bottoms are manufactured to the same **thickness and weight**.
- Manufactured to a **“Tru” mil thickness**.
- The difference is in the weight. **Aqua-Tru liners are the heaviest in the industry.**

### E-Z CLIP™ LINERS

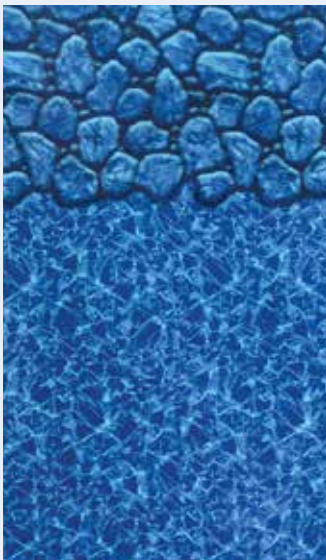

Pebble Springs



Blue Lagoon



Neptune



Trinity

# Liners: 100% Seam Warranty

## OVERLAP™ LINER PATTERNS



Caribbean Blue

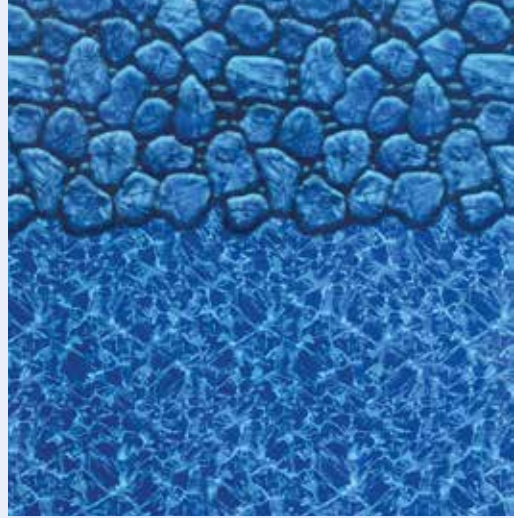

Pebble Springs



Harbor Lights



Solid Blue

# Standard Skimmer

Is an easy, effective way to help maintain pool water. Features include: large skimmer opening, tough, corrosion-resistant leaf basket, vacuum hook-up and a high-efficiency skimming weir.



AVAILABLE IN GRAY OR BEIGE

# Accessories



**MAJESTIC STEP**



**ROYAL II STEP**

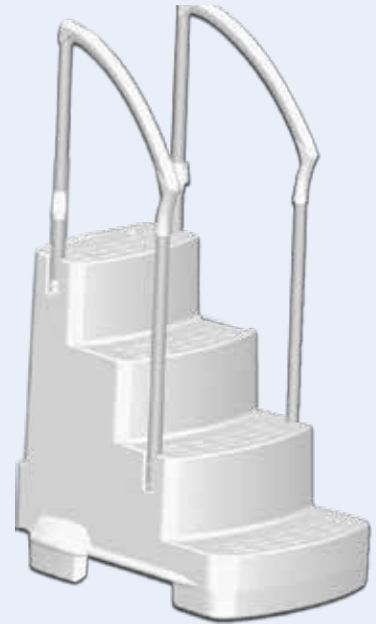

**FIESTA STEP**

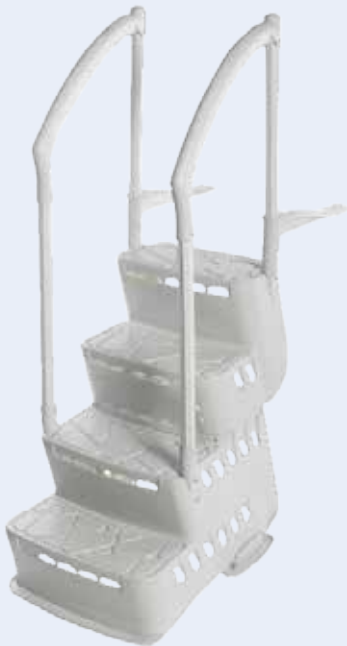

**BILTMORE STEP**



**H2O STEP**

## OPTIONAL LIGHT KITS



**Optional Halogen Light**  
Model #: 5-9025 LIGHT



**Innovalite LED Light**  
Model #: 5-9015 LIGHT



**Innovalite Solar Light**  
Model #: 5-9010 LIGHT